

























### Wiring diagrams

NO: Normally open

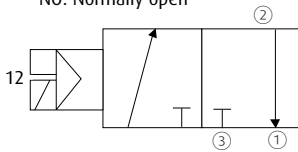

Assignment:

- ① = P (Vacuum supply)
- ② = A (Product side)
- ③ = R (Ventilation (Blow-off))

NC: Normally closed

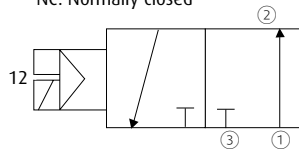

Assignment:

- ① = P (Ventilation (Blow-off))
- ② = A (Product side)
- ③ = R (Vacuum supply)

### Pilot valve



- > Manual mode for functional test: Setscrew in zero position
- > Automatic mode: Setscrew in position "1"

### Dimensions

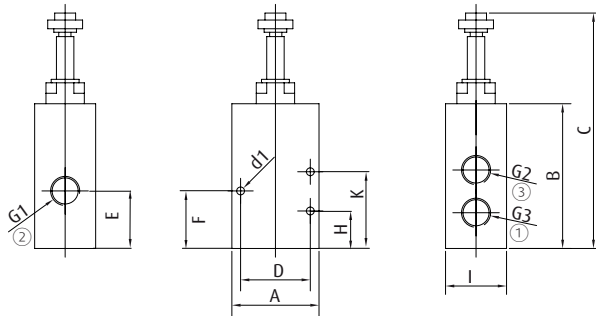

36.610 | 36.611

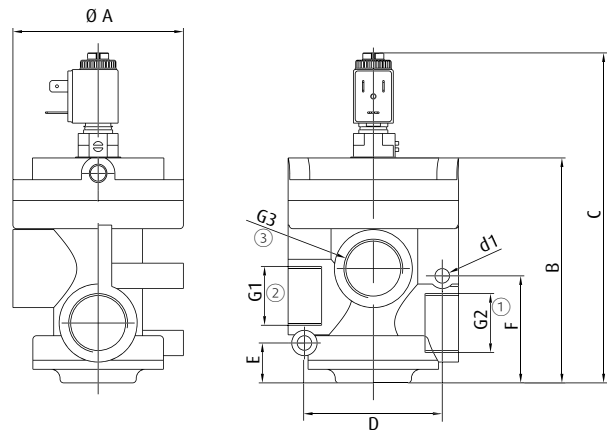

36.615 | 36.616 | 36.620 | 36.621 | 36.625 | 36.626

① = Vacuum supply / Ventilation (Blow-off) ② = Product side ③ = Ventilation (Blow-off) / Vacuum supply

Item no.	G1	G2	G3	Ø A [mm]	A [mm]	B [mm]	C [mm]	D [mm]	d1 [mm]	E [mm]	F [mm]	H [mm]	I [mm]	K [mm]
36.610	G3/8	G3/8	G3/8	--	50	83	137	40	4.5	22.5	33	21.5	35	44
36.611	G3/8	G3/8	G3/8	--	50	83	137	40	4.5	35	33	21.5	35	44
36.615	G1/2	G1/2	G1/2	75	--	101	155	63	6.5	22.5	55	--	--	--
36.616	G1/2	G1/2	G1/2	75	--	101	155	63	6.5	22.5	55	--	--	--
36.620	G3/4	G3/4	G3/4	75	--	101	155	63	6.5	22.5	55	--	--	--
36.621	G3/4	G3/4	G3/4	75	--	101	155	63	6.5	22.5	55	--	--	--
36.625	G1	G1	G1	94	--	124	178	63	8.2	22	58	--	--	--
36.626	G1	G1	G1	94	--	124	178	63	8.2	22	58	--	--	--

















